

Nova M3 MSD600 Sending Card Specifications

V2.0.0 2013-6-24

1. Functions



Nova M3 MSD600 is standard model of Nova sending card. It has the following characteristics:

- 1) HDMI/DVI input;
- 2) HDMI/external audio input;
- 3) 12bit/10bit/8bit HD video source;
- 4) Resolution supported:2048×1152 , 1920×1200 , 2560×960;
- 5) Resolution supported:1440×900; (12bit/10bit)

- 6) 1 light sensor interface;
- 7) Cascading supported;
- 8) 18bit gray scale processing and presentation;
- 9) Video format:RGB,YCrCb4:2:2,YCrCb4:4:4;

XI'AN NOVASTAR TECH CO., LTD

2. Dimensions and interface

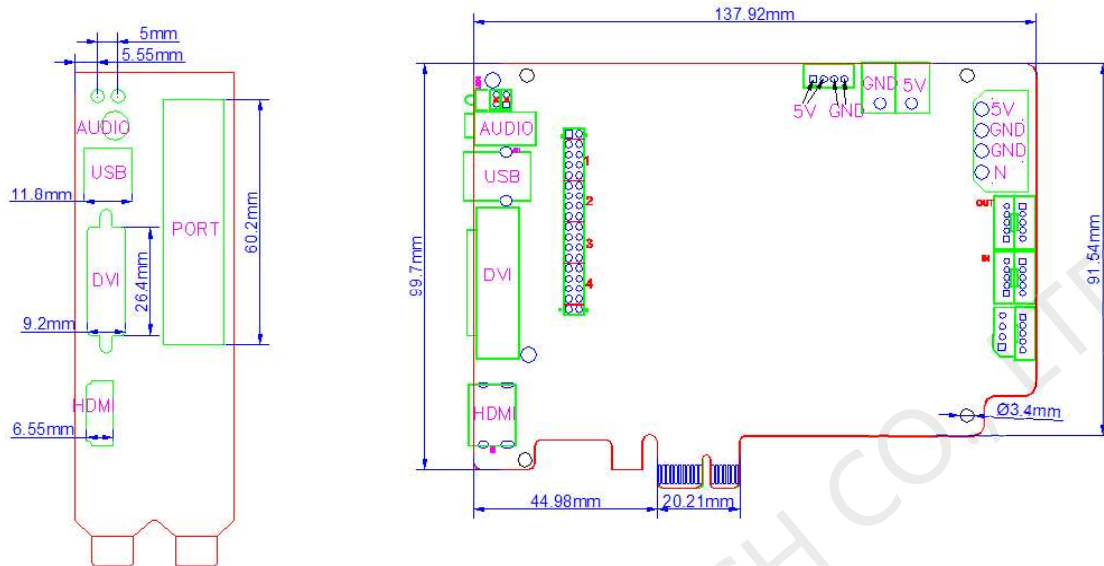

Fig. 1 MSD600 Dimensions and interface

3. Connection

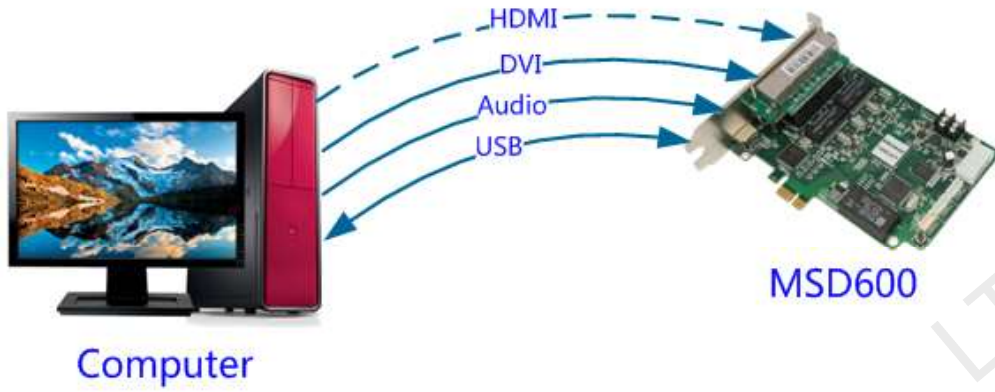

Fig. 2 Connection diagram

4. Working conditions

	Normal	Minimum	Maximum	Unit
Limit voltage		100	240	V
Working voltage		3.3	5.5	V
Working current	1.1			A
Working temperature		-20	60	°C
Working humidity		10	90	%